

HMP813001 MGB Wing Fitting Kit Instructions



Tex Automotive
A Member of the British Motor Heritage Group of Companies



© 2021 British Motor Heritage Limited

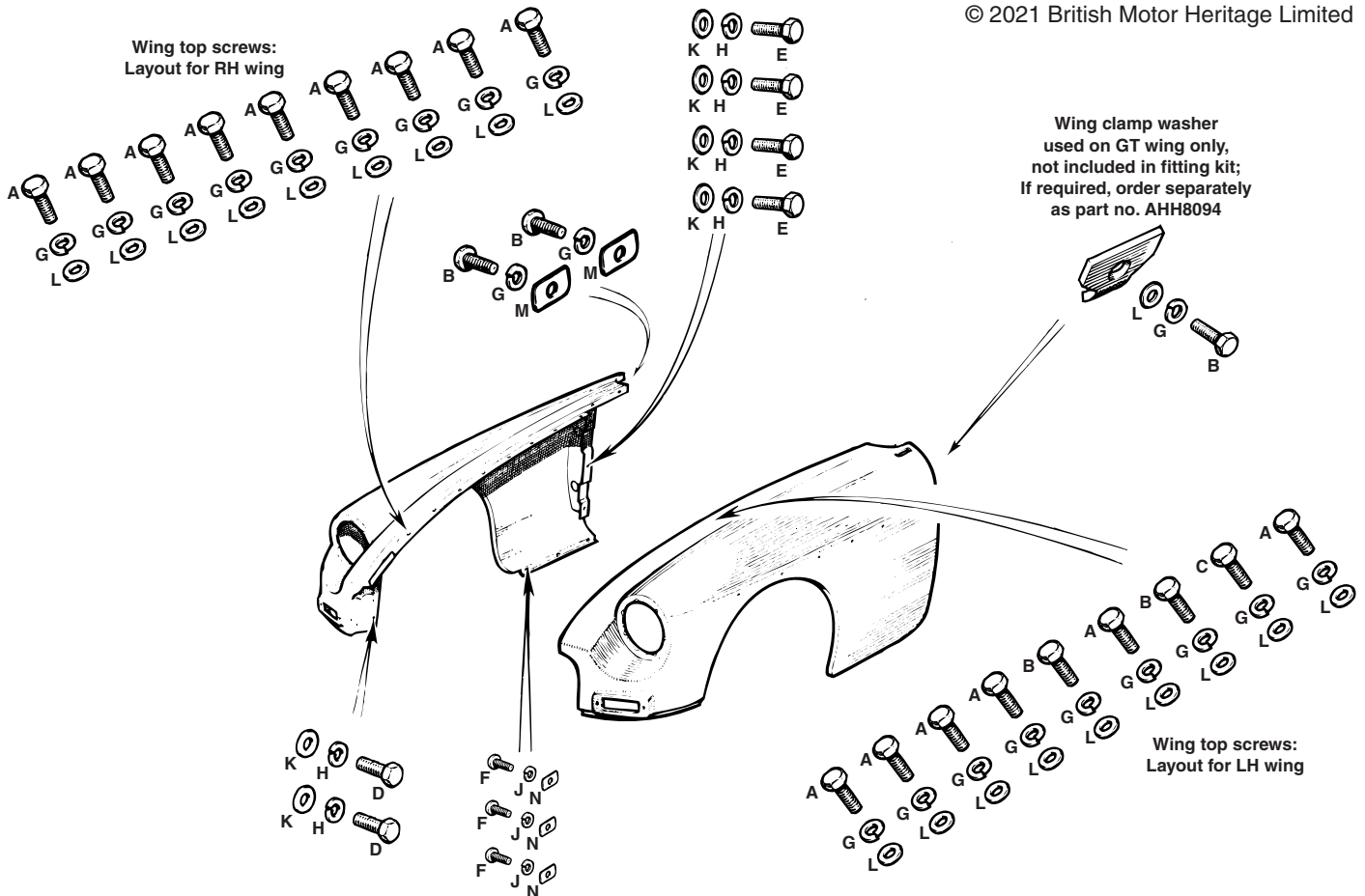

*This kit includes all fixings required for an MGB Roadster front wing and all but one fixing of those required on an MGB GT. The special clamping washer that secures the top of the wing to the A post on the MGB GT is not included and should be ordered separately (part number AHH8094).

*The alphabetical order of the screws in the illustration can be taken as a broadly suggested order for assembly. However, individual circumstances are likely to require changes to this order.

*Fit all screws loosely at first, to allow for panel adjustment during the wing fitting process. Only tighten the screws once they are all in place and, after tightening each one, check that you are still maintaining the optimal adjustment of the wing on the car.

*Only open out screw holes to achieve further adjustment if absolutely necessary. To do so breaks through the very important 'E Coat' corrosion resistant coating on the wing and, if a hole is opened out too much, the effectiveness of the fixing may be compromised.

*Always carry out a 'dry run' fitting of the wing, including any necessary adjustment of adjacent bolt-on panels, before fitting the wing permanently. Also check for satisfactory radiator grille fitment at each stage.

*After carrying out a satisfactory dry run and before fitting the wing permanently, it is recommended to brush a small amount of proprietary car body seam sealant very sparingly onto the wing's mating faces, avoiding clogging nut threads with sealant.

*A dab of anti-sieze copper grease on the threads should ensure the screws can be undone without difficulty in future, if need be.

*Please note that this kit is designed to be used with any MGB front wing. As such, once the wing has been fitted, there will be a few fixings left over. Roadster front wings do not require the included GT wing clamp fixings (1 each items L, G & B). Similarly, if the kit is used with a RH wing then items B (2 off) and C (1 off) are not required; on a LH wing item A (3 off) are not required.

*Also please note that the two large oval flat washers (M) on the wing to dash side joint changed to a rectangular shape on later cars. This was purely cost saving in production rather than improvement, so we prefer to offer the original, oval shaped washer.